



HEADSETS
TECHNICAL GUIDE

HEADSETS: BREAKDOWN

Headset selection can be tricky with such a wide variety of available options. This booklet is designed to simplify the process and help you find the right headset option to meet your requirements.

We now offer a separate TOP and BOTTOM headset option to help you tailor your selection more easily to your own head tube and fork combination.

All spare parts are now clearly listed, along with a Bearing Upgrade option to high quality, long life ceramic bearings.

HEADSET ASSEMBLY

TOP CUP ASSEMBLY

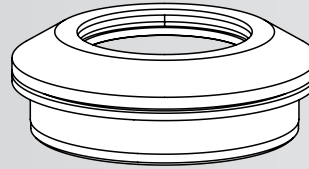

TOP COVER O-RING

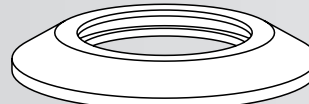

TOP COVER

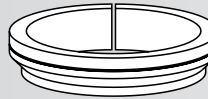

COMPRESSION RING



BEARING SEAL

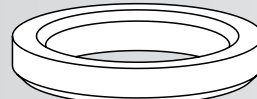

BEARING

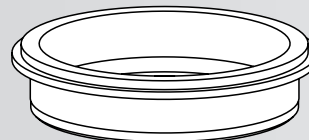

CUP

BOTTOM CUP ASSEMBLY

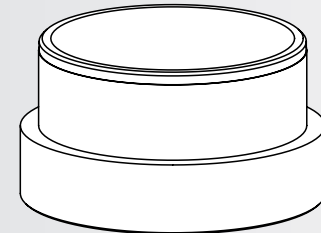
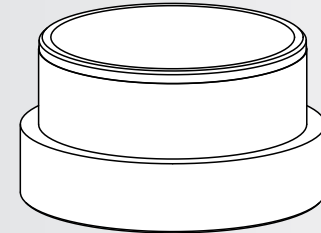

CUP

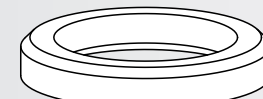

BEARING



BEARING SEAL



CROWN RACE



HEADSET CUP FINDER

1/8TH"

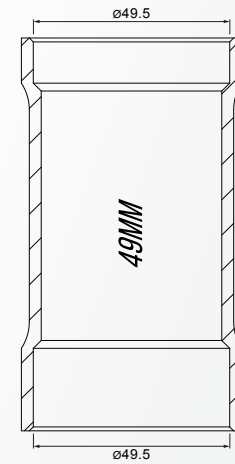
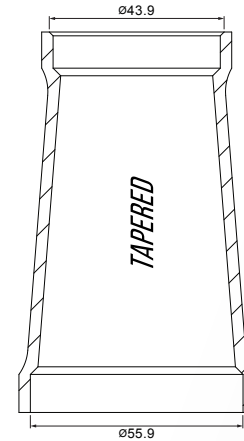
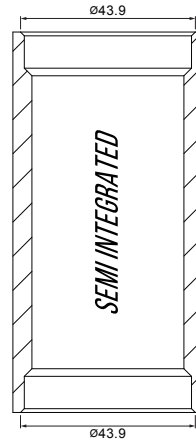
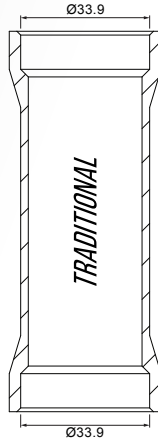
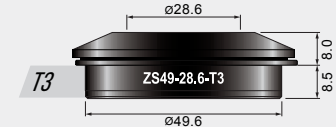
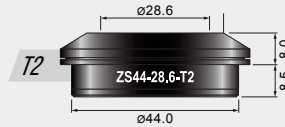
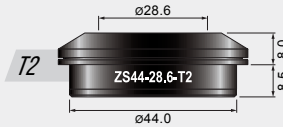
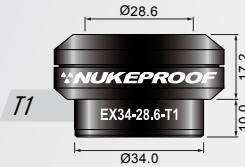

1/8TH"

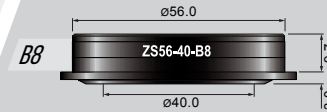
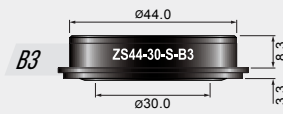
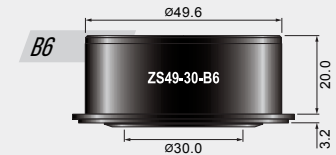
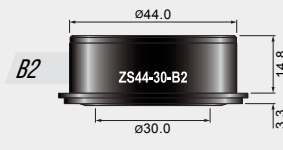
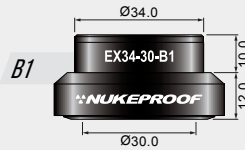

1.5" TO 1 1/8"
REDUCING CROWN

1/5"

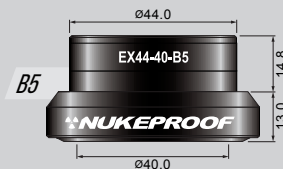

STILL DON'T KNOW WHICH HEADSET YOU NEED?

No problem! Simply follow the step by step guide on the next page to determine which size and type of headset you need for your frame.

STEP 1 Remove the fork from the frame and measure the steerer diameter for the top and the bottom in inches – a 1 1/8th fork will give 28.6mm for the top and approximately 30mm for the bottom, and 1.5" will give approximately 40mm for the bottom. *We do not provide a 1.5" top cup.

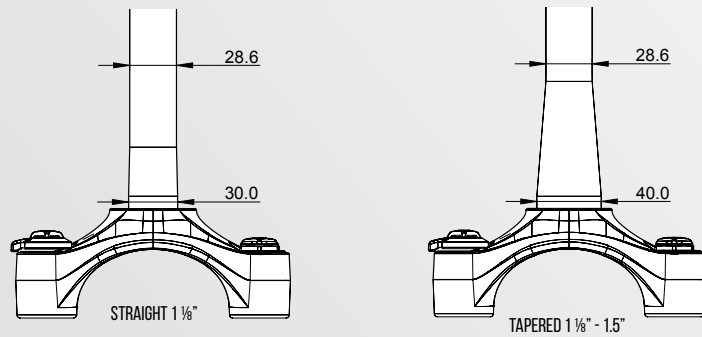

STEP 2 Measure the internal diameter of the head tube for both the top & bottom sections (after you have removed the headset cups from the frame).

POSSIBLE OPTIONS FOR TOP:
34MM, 44MM, 49MM



POSSIBLE OPTIONS FOR BOTTOM:
34MM, 44MM, 49MM, 56MM

STEP 3 Now use the numbers you got for steps 1 and 2 in the table below to find the required headset.

TOP HEADSET CUP OPTIONS

Internal diameter of head tube	Fork diameter (inches)	Cup needed for top (T)	Product Code	Ceramic bearing upgrade	Notes
34mm	1 1/8"	T1	EX34-28.6-T1	C1	Traditional 34mm
44mm	1 1/8"	T2	ZS44-28.6-T2	C1	Standard 44mm
49mm	1 1/8"	T3	ZS49-28.6-T3	C1	Reduced 49mm (1 1/8 th)

BOTTOM HEADSET CUP OPTIONS

Internal diameter of head tube	Fork diameter (inches)	Cup needed for bottom (B)	Product Code	Ceramic bearing upgrade	Notes
34mm	1 1/8"	B1	EX34-30-B1	C1	Traditional 34mm
	1 1/8"	B2	ZS44-30-B2	C1	Standard 44mm
	1 1/8"	B3	ZS44-30-S-B3	C1	Shallow cup 44mm
44mm	1 1/8"	B4	EX44-30-B4	C1	External 44mm increases stack)
	1.5"	B5	EX44-40-B5	C2	Tapered 44mm (1.5")
49mm	1 1/8"	B6	ZS49-30-B6	C1	Reduced 49mm (1 1/8 th)
	1.5"	B7	EX49-40-B7	C2	External 49mm (1.5")
56mm	1.5"	B8	ZS56-40-B8	C2	Standard 1.5"

SPECIALIST HEADSET OPTION AS1

The AS-1 allows you to alter the head angle by 1 degree in either direction in order to tailor the bike geometry to a more suitable configuration.

The AS-1 headset fits a 49mm head tube between 115mm and 130mm length with a 1 1/8th fork steerer.

Precision engineered to the most exacting tolerance, it delivers performance and durability without the side effects commonly found in other angle-adjust headsets.



 **NUKEPROOF**

WWW.NUKEPROOF.COM